

090366-wll
 DISTRIBUTION CENTER
 09 JUL 14 AM 7:41
 RECEIVED-FPSC
 COMMISSION CLERK
 09 JUL 14 AM 10:25

FLORIDA PUBLIC SERVICE COMMISSION

INSTRUCTIONS FOR COMPLETING
 APPLICATION FOR ORIGINAL CERTIFICATE
 FOR A PROPOSED OR EXISTING SYSTEM REQUESTING
 INITIAL RATES AND CHARGES

(Section 367.045, Florida Statutes)

General Information

The attached form has been prepared by the Florida Public Service Commission to aid utilities under its jurisdiction to file information required by Chapter 367, Florida Statutes, and Chapter 25-30, Florida Administrative Code. Any questions regarding this form should be directed to the Division of Economic Regulation, Bureau of Certification, Economics and Tariffs (850) 413-6900.

Instructions

1. Fill out the attached application form completely and accurately.
2. Complete all the items that apply to your utility. If an item is not applicable, mark it "N.A." Do not leave any items blank.
3. Notarize the completed application form.
4. Remit the proper filing fee pursuant to Rule 25-30.020, Florida Administrative Code, with the application.
5. The **original and five copies** of the completed application and attached exhibits; **one copy** of each territory and system map; the **original and two copies** of the proposed tariff(s); and the proper **filing fee** should be mailed to:

COM
 ECR Maps forwarded.
 GCL
 OPC
 RCP
 SSC
 SGA
 ADM
 CLK Henry

Office of Commission Clerk
 Florida Public Service Commission
 2540 Shumard Oak Boulevard
 Tallahassee, Florida 32399-0850

Check received with filing and forwarded to Fiscal for deposit. Fiscal to forward deposit information to Records.

Initials of person who forwarded check

[Handwritten signature]

DOCUMENT NUMBER-DATE
 07031 JUL 14 8
 FPSC-COMMISSION CLERK

PART X AFFIDAVIT

I ARNALDO BARRIOS (applicant) do solemnly swear or affirm that the facts stated in the foregoing application and all exhibits attached thereto are true and correct and that said statements of fact thereto constitutes a complete statement of the matter to which it relates.

BY: *Arnaldo Barrios*
Applicant's Signature

ARNALDO BARRIOS
Applicant's Name (Typed)

Managing Member
Applicant's Title *

Subscribed and sworn to before me this 9 day of July month
in the year of 2009 by Arnaldo Barrios who is personally known to
me ✓ or produced identification _____.

Type of Identification Produced
Susan R Jenkins
Notary Public's Signature

Print, Type or Stamp Commissioned
Name of Notary Public **SUSAN R JENKINS**
MY COMMISSION # DD840664
EXPIRES November 23, 2012
FloridaNotaryService.com
(407) 398-0153

* If applicant is a corporation, the affidavit must be made by the president or other officer authorized by the by-laws of the corporation to act for it. If applicant is a partnership or association, a member of the organization authorized to make such affidavit shall execute same.

C) Indicate the organizational character of the applicant: (circle one)

Corporation Partnership Sole Proprietorship
Other (Specify) _____

D) If the applicant is a corporation, indicate whether it has made an election under Internal Revenue Code Section 1362 to be an S Corporation:

Yes No

E) If the applicant is a corporation, list names, titles and addresses of corporate officers, directors, partners, or any other person(s) or entities owning an interest in the applicant's business organization. (Use additional sheet if necessary).

ARNOLD BARROS 900 WASHINGTON ST. HOLLYWOOD FL. 33019
MARIA BARROS 900 WASHINGTON ST. HOLLYWOOD FL. 33019

F) If the applicant is not a corporation, list names and addresses of all persons or entities owning an interest in the organization. (Use additional sheet if necessary.)

PART II NEED FOR SERVICE

A) Exhibit A - A statement regarding the need for service in the proposed territory, such as anticipated (or actual) development in the area. Identify any other utilities within the area proposed to be served which could potentially provide such service in the area and the steps the applicant took to ascertain whether such other service is available.

B) Exhibit B - A statement that to the best of the applicant's knowledge, the provision of service will be consistent with the water and wastewater sections of the local comprehensive plan, as approved by the Department of Community Affairs at the time the application is filed. If the provision of service is inconsistent with such plan, provide a statement demonstrating why granting the certificate would be in the public interest.

ARMA WATER SERVICE, LLC

EXHIBIT A

Due to regulations in Marion County Florida, Single or Multi-Family homes cannot be permitted for construction unless one or more of the following conditions is met. Five acre tract, public and Department of Environmental Protection permitted water or wastewater system, on any lot less than five acres. The above is to the best of my knowledge.

Mr. and Mrs. Barros had no choice but to install a permitted water system in order to build single and multi-family units.

ARMA WATER SERVICE, LLC

EXHIBIT B

The water system is permitted by the Florida Department of Environmental Protection and is consistent with the water sections of the local comprehensive plan, as approved by the Department of Community Affairs at the time this application is filed

ARMA WATER SERVICE, LLC

EXHIBIT C

Water system will only serve potable water to residential consumers

ARMA WATER SERVICE, LLC

EXHIBIT D

There are 58 total residential connections proposed to be served using standard house type meters 5/8 x 3/4 inch .

**Water utility is in service servicing 22 duplex units
Standard house type meters 5/8 x 3/4 inch.
This system only serves residential customers**

PART III SYSTEM INFORMATION

A) WATER

- (1) Exhibit C - A statement describing the proposed type(s) of water service to be provided (i.e., potable, non-potable or both).
- (2) Exhibit D - The number of equivalent residential connections (ERCs) proposed to be served, by meter size and customer class. If development will be in phases, separate this information by phase. In addition, if the utility is in operation, provide the current number of ERCs by meter size and customer class.
- (3) Description of the types of customers anticipated (i.e., single family, mobile homes, clubhouse, commercial, etc.):

 Residential, Single family, and Duplex houses

- (4) In the case of an existing utility, provide the permit number and the date of approval of facilities by the Department of Environmental Protection (DEP) or the agency designated by DEP to issue permits:

 Permit Number WD-42-0246114-002 Dated June 16, 2005

- (5) Indicate the design capacity of the treatment plant in terms of equivalent residential connections (ERCs) and gallons per day (gpd). If development will be in phases, separate this information by phase.

 94 Res. Connections (ERCs) 65,800 (GPD)

- (6) Indicate the type of treatment: Liquid Chlorine

- (7) Indicate the design capacity of the transmission and distribution lines in terms of ERCs and gpd. If development will be in phases, separate this information by phase.

 94 Residential Connections 65,800 gpd.

- (8) Provide the date the applicant began or plans to begin serving customers:

 Serving 22 connections as of this date

ARMA WATER SERVICE, LLC

EXHIBIT E

**Warranty deed will be filed as soon as possible,
As the owners are separating the land for the water treatment plant**

- (9) Exhibit E - Evidence, in the form of a warranty deed, that the utility owns the land where the water facilities are or will be located. If the utility does not own the land, a copy of the agreement which provides for the long term continuous use of the land, such as a 99-year lease. The Commission may consider a written easement or other cost-effective alternative.

The applicant may submit a contract for the purchase and sale of land with an unexecuted copy of the warranty deed provided the applicant files an executed and recorded copy of the deed, or executed copy of the lease, within thirty days after the order granting the certificate.

B) WASTEWATER

- (1) Exhibit N/A - The number of equivalent residential connections (ERCs) proposed to be served, by meter size and customer class. If development will be in phases, separate this information by phase. In addition, if the utility is in operation, provide the current number of ERCs by meter size and customer class.

- (2) Description of the types of customers anticipated (i.e., single family, mobile homes, clubhouse, commercial, etc.):

N/A

- (3) In the case of an existing utility, provide the permit number and the date of approval of facilities by the Department of Environmental Protection (DEP) or the agency designated by DEP to issue permits:

N/A

- (4) Indicate separately the design capacity of the treatment plant and effluent disposal system in terms of equivalent residential connections (ERCs) and gallons per day (GPD). If development will be in phases, separate this information by phase.

N/A

- (5) Indicate the method of treatment and disposal (percolation pond, spray field, etc.):

N/A

(6) Exhibit N/A - If the applicant does not propose to use reuse as a means of effluent disposal, provide a statement that describes, with particularity, the reasons for not using reuse.

(7) Indicate the design capacity of the collection lines in terms of ERCs and GDP. If development will be in phases, separate this information by phase.

N/A

(8) Provide the date the applicant began or plans to begin serving customers:
N/A

(9) Exhibit N/A - Evidence, in the form of a warranty deed, that the utility owns the land where the utility treatment facilities are or will be located. If the utility does not own the land, a copy of the agreement which provides for the long term continuous use of the land, such as a 99-year lease.

The Commission may consider a written easement or other cost-effective alternative. The applicant may submit a contract for the purchase and sale of land with an unexecuted copy of the warranty deed, provided the applicant files an executed and recorded copy of the deed, or executed copy of the lease, within thirty days after the order granting the certificate.

PART IV FINANCIAL AND TECHNICAL INFORMATION

A) Exhibit F - A statement regarding the financial and technical ability of the applicant to provide reasonably sufficient and efficient service.

B) Exhibit G - A detailed financial statement (balance sheet and income statement), certified if available, of the financial condition of the applicant, showing all assets and liabilities of every kind and character. The income statement shall be for the preceding calendar or fiscal year. If an applicant has not operated for a full year, then the income statement shall be for the lesser period. The financial statement shall be prepared in accordance with Rule 25-30.115, Florida Administrative Code. If available, a statement of the source and application of funds shall also be provided.

C) Exhibit H - A list of all entities, including affiliates, upon which the applicant is relying to provide funding to the utility, and an explanation of the manner and amount of such funding, which shall include their financial statements and any financial agreements with the utility. This requirement shall not apply to any person or entity holding less than 10 percent ownership interest in the utility.

ARMA WATER SERVICE, LLC

**EXHIBIT
F, G, H.**

Confidential financial statement.

Will be provided at a later date by owners of LLC

- D) Exhibit I - A schedule showing the projected cost of the proposed system (or actual cost of the existing system) by uniform system of accounts (USOA) account numbers pursuant to Rule 25-30.115, F.A.C. In addition, provide the capacity of each component of the system in ERCs and gallons per day. If the utility will be built in phases, this schedule shall apply to the design capacity of the first phase only. Provide a separate exhibit for the water and wastewater systems.
- E) Exhibit J - A schedule showing the projected operating expenses of the proposed system by USOA account numbers when 80 percent of the designed capacity of the system is being utilized. If the utility will be built in phases, this schedule shall apply to the design capacity of the first phase only. In addition, if the utility has been in existence for at least one year, provide actual operating expenses for the most recent twelve months. Provide a separate exhibit for the water and wastewater systems.
- F) Exhibit N/A - A schedule showing the projected capital structure, including the methods of financing the construction and operation of the utility until the utility reaches 80 percent of the designed capacity of the system(s).
- G) Exhibit N/A - A cost study, including customer growth projections, which supports the proposed rates, miscellaneous service charges, customer deposits and service availability charges. A sample cost study is enclosed with the application package. Provide a separate cost study for the water and wastewater systems.
- H) Exhibit N/A - If the base facility and usage rate structure (as defined in Rule 25-30.437(6), F.A.C.) is not utilized for metered service, provide an alternative rate structure and a statement supporting why the alternative is appropriate.
- I) Exhibit N/A - If a different return on common equity other than the current equity leverage formula established by order of the Public Service Commission pursuant to Section 367.081(4), F.S. is utilized, provide competent substantial evidence supporting the use of a different return on common equity. Information on the current equity leverage formula may be obtained by contacting the accounting section at the listed number.

PART V ALLOWANCE FOR FUNDS USED DURING CONSTRUCTION (AFUDC)

Please note the following:

- A) Utilities obtaining initial certificates pursuant to Rule 25-30.033, F.A.C., are authorized to accrue AFUDC for projects found eligible pursuant to Rule 25-30.116(1), F.A.C.
- B) A discounted monthly AFUDC rate calculated in accordance with Rule 25-30.116(3),

Company ARMA WATER SERVICE LLC**Pro Forma Water Utility Plant**Date 07-11, 2009

<u>Acct. No.</u>		
301.	Organization	\$ <u>6,200</u>
302.	Franchises	\$ <u>0</u>
303.	Land and Land Rights	\$ <u>40,000</u>
304.	Structures and Improvements	\$ <u>12,600</u>
305.	Collecting and Impounding Reservoirs	\$ <u>0</u>
306.	Lake, River and Other Intakes	\$ <u>0</u>
307.	Wells and Springs	\$ <u>24,000</u>
309.	Supply Mains	\$ <u>6,300</u>
310.	Power Generation Equipment	\$ <u>0</u>
311.	Pumping Equipment	\$ <u>19,800</u>
320.	Water Treatment Equipment	\$ <u>36,400</u>
330.	Distribution Reservoirs and Standpipes	\$ <u>2,400</u>
331.	Transmission and Distribution Mains	\$ <u>196,500</u>
333.	Services	\$ <u>12,200</u>
334.	Meters and Meter Installation	\$ <u>14,600</u>
335.	Hydrants	\$ <u>0</u>
339.	Other Plant and Miscellaneous Equipment	\$ <u>1,800</u>
340.	Office Furniture and Equipment	\$ <u>2,200</u>
341.	Transportation Equipment	\$ <u>0</u>
343.	Tools, Shop and Garage Equipment	\$ <u>0</u>
345.	Power Operated Equipment	\$ <u>0</u>
348.	Other Tangible Plant	\$ <u>0</u>
		\$ <u><u>375,700</u></u>

Treatment Capacity	<u>65,800</u> GPD	<u>94</u> ERCs
Line Capacity	65,800	<u>94</u> ERCs
	ERC = <u>65,800</u> GPD	

EXHIBIT J

Company ARMA WATER SERVICE LLC

Pro Forma Schedule of Expenses for Water Utility

Date 07-11, 2009

<u>Acct. No.</u>		
601.	Salaries and Wages - Employees	\$ <u>0</u>
603.	Salaries and Wages - Other	\$ <u>0</u>
604.	Employees Pensions and Benefits	\$ <u>0</u>
610.	Purchased Water	\$ <u>0</u>
615.	Purchased Power	\$ <u>1,617.04</u>
616.	Fuel for Power Production	\$ <u>0</u>
618.	Chemicals	\$ <u>415.00</u>
620.	Materials and Supplies	\$ <u>0</u>
630.	Contractual Services	\$ <u>2,820.00</u>
640.	Rents	\$ <u>0</u>
650.	Transportation Expense	\$ <u>0</u>
655.	Insurance Expense	\$ <u>3,220.14</u>
665.	Regulatory Commission Expense	\$ <u>750.00</u>
670.	Bad Debt Expense	\$ <u>0</u>
675.	Miscellaneous Expense	\$ <u>1,250.00</u>
403.	Depreciation Expense	\$ <u>0</u>
407.	Amortization Expense - Other	\$ <u>0</u>
408.	Taxes Other Than Income	\$ <u>0</u>
409.	Income Taxes	\$ <u>0</u>
	Total Expenses	\$ <u>10,072.18</u>
	Average cost per customer per month	\$ <u>38.15</u>

ARMA WATER SERVICE, LLC

EXHIBIT K

Township 16 South, Range 21 East, Marion County, Florida

Section 23

The north $\frac{1}{2}$ of the center $\frac{1}{2}$ and the north $\frac{1}{2}$ of East Section 23

Marion County Property Appraiser

Ville M. Smith, CFA, ASA

Property Focus Map

EXHIBIT L

WARNING: These maps are no longer being maintained and will soon be discontinued. A new mapping system will be provided at that

Section Map. 165 C4 231621

ARMA WATER SERVICE LLC

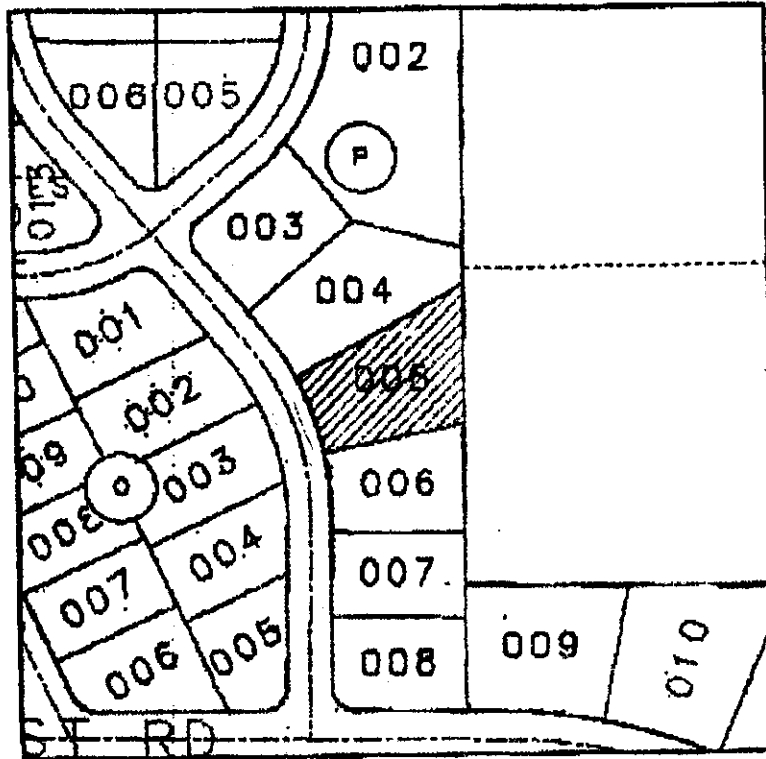

Data Summary for Parcel 3570-016-005

Owner Name	A N B REAL ESTATES INVEST INC
Situs Address	
Section/Town/Range	23 16 21
Property Acreage	0.50

Exhibit N

APPLICATION FOR ORIGINAL CERTIFICATE

(Section 367.045, Florida Statutes)

LEGAL NOTICE

Notice is hereby given on 7-11-2009, Pursuant to Section 367.045, Florida Statutes, Of the application of ARMA WATER SERVICE, LLC to operate a water utility to provide service to the following described territory in Marion County, Florida.

Section 23 Township 16 Range 21 located at the north section of Leighton Estates.
County road 475A and SW 32 Ave. Rd.

Any objection to the said application must be made in writing and filed with the office of the Commission Clerk, Florida Public Service Commission, 2540 Shumard Oak Boulevard, Tallahassee, Florida 32399-0850, within thirty (30) days of this notice.

At the same time a copy of said objection should be mailed to the applicant whose address is set forth below. The objection must state the grounds for the objection with particularity.

ARMA WATER SERVICE LLC
900 Washington Street
Hollywood FL, 33019

F.A.C., shall be used to insure that the annual AFUDC charged does not exceed authorized levels.

- C) The date the utility shall begin to charge the AFUDC rate shall be the date the certificate of authorization is issued to the utility so that such rate can apply to initial construction of the utility facilities.

PART VI TERRITORY DESCRIPTION AND MAPS

A) TERRITORY DESCRIPTION

Exhibit K - An accurate description, using township, range and section references as specified in Rule 25-30.030(2), Florida Administrative Code. If the water and wastewater service territories are different, provide separate descriptions.

B) TERRITORY MAPS

Exhibit L - One copy of an official county tax assessment map or other map showing township, range and section with a scale such as 1"=200' or 1"=400' on which the proposed territory is plotted by use of metes and bounds or quarter sections and with a defined reference point of beginning. If the water and wastewater service territories are different, provide separate maps.

C) SYSTEM MAPS

Exhibit M - One copy of detailed map(s) showing proposed lines, facilities and the territory proposed. **Additionally, identify any existing lines and facilities.** Map(s) should be of sufficient scale and detail to enable correlation with a description of the territory to be served. Provide separate maps for water and wastewater systems.

PART VII NOTICE OF ACTUAL APPLICATION

- A) Exhibit N - An affidavit that the notice of actual application was given in accordance with Section 367.045(1)(a), Florida Statutes, and Rule 25-30.030, Florida Administrative Code, by regular mail to the following:

- (1) the governing body of the municipality, county, or counties in which the system or the territory proposed to be served is located;
- (2) the privately owned water and wastewater utilities that hold a certificate granted by the Public Service Commission and that are located within the county in which the utility or the territory proposed to be served is located;

- (3) if any portion of the proposed territory is within one mile of a county boundary, the utility shall notice the privately owned utilities located in the bordering counties and holding a certificate granted by the Commission;
- (4) the regional planning council;
- (5) the Office of Public Counsel;
- (6) the Public Service Commission's Director of the Division of the Commission Clerk and Administrative Services;
- (7) the appropriate regional office of the Department of Environmental Protection; and
- (8) the appropriate water management district.

Copies of the Notice and a list of entities noticed shall accompany the affidavit.
THIS MAY BE A LATE-FILED EXHIBIT

- B) Exhibit O - An affidavit that the notice of actual application was given in accordance with Rule 25-30.030, Florida Administrative Code, by regular mail or personal delivery to each customer of the system. A copy of the notice shall accompany the affidavit. THIS MAY BE A LATE-FILED EXHIBIT.
- C) Exhibit P - Immediately upon completion of publication, an affidavit that the notice of actual application was published once in a newspaper of general circulation in the territory in accordance with Rule 25-30.030, Florida Administrative Code. A copy of the proof of publication shall accompany the affidavit. THIS MAY BE A LATE-FILED EXHIBIT.

PART VIII FILING FEE

Indicate the filing fee enclosed with the application:

\$ 750.00 (for water) and \$ N/A (for wastewater).

Note: Pursuant to Rule 25-30.020, Florida Administrative Code, the amount of the filing fee as follows:

- (1) For applications in which the utility has the capacity to serve up to 500 ERCs, the filing fee shall be **\$750.**
- (2) For applications in which the utility has the capacity to serve from 501 to 2,000 ERCs the filing fee shall be **\$1,500.**

Revenue Proof for Water Utility

EXHIBIT Q

ARMA WATER SERVICE, LLC

Requested Rates – Residential – Monthly

Base Facility Charge

5/8" X 3/4	Meter	\$ 21.45
1"	Meter	48.50
1-1/2"	Meter	76.25
2"	Meter	94.12
<u>Charge per 1,000 gallons</u>		\$ 1.62
94 ERCs X 12 Months x \$ 21.45	=	\$ 24,195.60
94 X 350 GPD = 32,900 32,900 GPD X 365 X 1.62	=	\$ 53,298.00
Water Revenue at 100 % of design Capacity		\$ 77,493.00

Note:

The requested rates are designed to cover operating expenses at 100% of design capacity and allow a fair rate of return on rate base. Due to the current economy the design capacity may not be met for several years.

- (3) For applications in which the utility has the capacity to serve from 2,001 to 4,000 ERCs the filing fee shall be **\$2,250**.
- (4) For applications in which the utility has the capacity to serve more than 4,000 ERCs the filing fee shall be **\$3,000**.

PART IX TARIFF

Exhibit Q - The original and two copies of water and/or wastewater tariff(s) containing all rates, classifications, charges, rules and regulations. Sample tariffs are enclosed with the application package.

Questionnaire

1. Number of connections anticipated:

<u>WATER</u>	1 st Year	2 nd Year	3 rd Year
Residential 5/8" x 3/4" meter	<u>22</u>	<u>35</u>	<u>45</u>
Residential <u>1</u> " meter	<u>0</u>	<u>0</u>	<u>0</u>
Multiple dwelling units	<u>22</u>	<u>30</u>	<u>50</u>
Commercial	<u>0</u>	<u>0</u>	<u>0</u>
Fire Protection	<u>0</u>	<u>0</u>	<u>0</u>
TOTAL	<u><u>22</u></u>	<u><u>35</u></u>	<u><u>45</u></u>

<u>WASTEWATER</u>	1 st Year	2 nd Year	3 rd Year
Residential	<u>N/A</u>	<u>N/A</u>	<u>N/A</u>
Multiple dwelling units	<u></u>	<u></u>	<u></u>
Commercial	<u></u>	<u></u>	<u></u>
TOTAL	<u></u>	<u></u>	<u></u>

2. Describe the anticipated type of customers, i.e., mobile homes, condominiums, single family, retirement areas, golf courses, pools, clubhouses, industrial, etc.

Single and Duplex residential houses

3. How many years will it take for the utility to reach design capacity? 3-6

4. Give the approximate date you anticipate having your first connection.
Water system is in service at this time

5. Do you anticipate future expansion or additional phases of construction? No
 (Yes or No)

Questionnaire, continued

6. Describe briefly any developer agreements you anticipate and enclose a copy of any existing agreements, i.e., contributions of lines, etc. _____

N/A

Attachment No. _____

7. Attach a copy of the deed for the land on which the plant facilities are located.

Attachment No. _____

8. Provide number and date of issuance of any permit(s) obtained from Florida Department of Environmental Protection for construction of water or wastewater facilities. PWS ID Number 3425108 Issued August 8, 2005

9. Estimated gallons of water to be sold per month, at 80% of design capacity, by customer class:

Residential 5/8" x 3/4" meter	<u>26,000</u>
Residential <u>1</u> " meter	<u>0</u>
Multiple dwelling units	<u>26,000</u>
Commercial	<u>0</u>
Fire Protection	<u>0</u>

10. Describe the water treatment system, i.e., number of wells, storage capacity, type of water treatment. 2-5" public use wells. 5000 gallon water storage tank. Treatment is disinfection using chlorine injection with chlorine feed pump.

Questionnaire, continued

11. Estimated gallons of wastewater to be treated per month, at 80% of design capacity, by customer class:

Residential	N/A
Multiple dwelling units	N/A
Commercial	N/A

12. Describe the wastewater treatment system, i.e., ponds, type of wastewater treatment, etc. N/A

13. Provide evidence that the utility will have adequate financial backing.
Attachment No. _____

Cost Justification for Meter Installation Fees

	5/8 x 3/4"	1"	1-1/2"	Other
Meter	\$ <u>52.00</u>	\$ <u>127.00</u>	\$ <u>210.00</u>	\$ <u>N/A</u>
Meter Box	<u>14.00</u>	<u>14.00</u>	<u>26.00</u>	<u>N/A</u>
Fitting and Curb Stop	<u>24.00</u>	<u>31.00</u>	<u>45.00</u>	<u>N/A</u>
Labor @ \$ <u>65.00</u> per hour	<u>65.00</u>	<u>65.00</u>	<u>65.00</u>	<u>N/A</u>
Overhead @ \$ <u>75.00</u> per hour	<u> </u>	<u> </u>	<u> </u>	<u> </u>
Total	\$ <u>155.00</u>	\$ <u>237.00</u>	\$ <u>346.00</u>	\$ <u>N/A</u>

Cost Justification for Miscellaneous Service Charges

	<u>Charge During Regular Business Hours</u>	<u>Charge After Regular Business Hours</u>
Initial Connection:	\$ <u>25.00</u>	\$ <u>50.00</u>
Normal Reconnection:	\$ <u>20.00</u>	\$ <u>50.00</u>
Violation Reconnection:	\$ <u>25.00</u>	\$ <u>50.00</u>
Premise Visit Charge:	\$ <u>50.00</u>	\$ <u>75.00</u>

Note:

A request for approval of miscellaneous service charges must be accompanied by supporting cost justification which clearly reflects the costs incurred to provide the particular miscellaneous service and the requested charges are reasonable fees as required by our rules.