

**David Christian**  
Assistant Vice President  
Regulatory Affairs Florida



106 E. College Ave  
Tallahassee, Florida 32301  
Telephone 850-224-3963  
Fax 850-222-2912  
david.christian@verizon.com

March 2, 2006

Ms. Beth W. Salak, Director  
Division of Competitive Markets and Enforcement  
Florida Public Service Commission  
2540 Shumard Oak Boulevard  
Tallahassee, FL 32399-0850

Dear Ms. Salak:

Attached are new tariff pages filed to become part of the Verizon Florida Inc. General Services Tariff. For a list of impacted tariff sheets see Attachment A.

The purpose of this filing is to redefine the descriptions of the Hudson and Tampa North exchange boundary maps and make some administrative changes. There is no impact to customer service with this exchange boundary filing.

If you require additional information, please call Carlton Ball at (813) 483-2529.

Sincerely,  
David M. Christian  
Assistant Vice President  
Regulatory Affairs Florida

DMC:sv  
Attachments

Attachment A

**Verizon Florida Inc.  
General Services Tariff**

Section A200 Local Exchange Service Area Maps and Descriptions

2nd Revised Contents Page 1  
2nd Revised Contents Page 2  
2nd Revised Contents Page 3  
Original Contents Page 4  
3rd Revised Page 24  
4th Revised Page 25  
4th Revised Page 26  
4th Revised Page 41  
5th Revised Page 66  
8th Revised Page 67  
6th Revised Page 82  
4th Revised Page 83  
Original Page 83.1  
9th Revised Page 84

A200. LOCAL EXCHANGE SERVICE AREA MAPS AND DESCRIPTIONS

	<u>CONTENTS</u>	<u>Page No.</u>
<u>EXCHANGE</u>		
A200.1	<u>Bartow</u>	
	A200.1.1 (Deleted)	
	A200.1.2 Exchange Area Description	2
	A200.1.3 Exchange Service Area Map	3
A200.2	<u>Bradenton</u>	
	A200.2.1 (Deleted)	
	A200.2.2 Exchange Area Description	5
	A200.2.3 Exchange Service Area Map	7
A200.3	<u>Clearwater</u>	
	A200.3.1 (Deleted)	
	A200.3.2 Exchange Area Description	9
	A200.3.3 Exchange Service Area Map	11
A200.4	<u>Englewood</u>	
	A200.4.1 (Deleted)	
	A200.4.2 Exchange Area Description	13
	A200.4.3 Exchange Service Area Map	14
A200.5	<u>Frostproof</u>	
	A200.5.1 (Deleted)	
	A200.5.2 Exchange Area Description	16
	A200.5~3 Exchange Service Area Map	17
A200.6	<u>Haines City</u>	
	A200.6.1 (Deleted)	
	A200.6.2 Exchange Area Description	19
	A200.6.3 Exchange Service Area Map	21
	A200.6.4 Poinciana Exception Area by Metes and Bounds	22
	A200.6.5 Poinciana Exception Area Service Map	23
A200.7	<u>Hudson</u>	
	A200.7.1 Exchange Area Description	24
	A200.7.2 Exchange Service Area Map	26
		(D) (C) (C)
A200.8	<u>Indian Lake</u>	
	A200.8.1 (Deleted)	
	A200.8.2 Exchange Area Description	28
	A200.8.3 Exchange Service Area Map	29

(M) Material moved to Contents Page 2. (M)  
(N)

A200. LOCAL EXCHANGE SERVICE AREA MAPS AND DESCRIPTIONS

		<u>CONTENTS</u>	<u>Page No.</u>	
<u>EXCHANGE</u>				
A200.9	<u>Lakeland</u>			(M)
	A200.9.1	(Deleted)		
	A200.9.2	Exchange Area Description	31	
	A200.9.3	Exchange Service Area Map	32	
A200.10	<u>Lake Wales</u>			
	A200.10.1	(Deleted)		
	A200.10.2	Exchange Area Description	34	
	A200.10.3	Exchange Service Area Map	35	(M)
A200.11	<u>Mulberry</u>			
	A200.11.1	(Deleted)		
	A200.11.2	Exchange Area Description	37	
	A200.11.3	Exchange Service Area Map	38	
A200.12	<u>Myakka</u>			(D)
	A200.12.1	Exchange Area Description	39	(C)
	A200.12.2	Exchange Service Area Map	41	(C)
A200.13	<u>New Port Richey</u>			
	A200.13.1	(Deleted)		
	A200.13.2	Exchange Area Description	43	
	A200.13.3	Exchange Service Area Map	44	
A200.14	<u>North Port</u>			
	A200.14.1	(Deleted)		
	A200.14.2	Exchange Area Description	46	
	A200.14.3	Exchange Service Area Map	47	
A200.15	<u>Palmetto</u>			
	A200.15.1	(Deleted)		
	A200.15.2	Exchange Area Description	49	
	A200.15.3	Exchange Service Area Map	50	
A200.16	<u>Plant City</u>			
	A200.16.1	(Deleted)		
	A200.16.2	Exchange Area Description	53	
	A200.16.3	Exchange Service Area Map	55	

(M) Material moved from Contents Page 2 (M')  
 (M') Material moved to Contents Page 3. (N)  
(N)

A200. LOCAL EXCHANGE SERVICE AREA MAPS AND DESCRIPTIONS

		<u>CONTENTS</u>	<u>Page No.</u>	
<u>EXCHANGE</u>				
A200.17	<u>Polk City</u>			(M)
	A200.17.1	(Deleted)		
	A200.17.2	Exchange Area Description	58	
	A200.17.3	Exchange Service Area Map	59	
A200.18	<u>St. Petersburg</u>			
	A200.18.1	(Deleted)		
	A200.18.2	Exchange Area Description	61	
	A200.18.3	Exchange Service Area Map	63	
A200.19	<u>Sarasota</u>			
	A200.19.1	Exchange Area Description	64	(D)
	A200.19.2	Exchange Service Area Map	67	(C)
A200.20	<u>Tampa</u>			
	A200.20.1	(Deleted)		
	A200.20.2	Exchange Area Description	71	
	A200.20.3	Exchange Service Area Map	74	
	A200.20.4	Metropolitan Exchange Service Area Map	77	
	A200.20.5	Airport Service Area Map	78	(M)
	A200.20.6	Tampa-Central	79	
	A200.20.7	Tampa-North	82	
	A200.20.8	Tampa-East	85	
	A200.20.9	Tampa-South	89	
	A200.20.10	Tampa-West	91	
A200.21	<u>Tarpon Springs</u>			
	A200.21.1	(Deleted)		
	A200.21.2	Exchange Area Description	95	
	A200.21.3	Exchange Service Area Map	97	
A200.22	<u>Venice</u>			
	A200.22.1	(Deleted)		
	A200.22.2	Exchange Area Description	99	
	A200.22.3	Exchange Service Area Map	100	

(M) Material moved from Contents Page 3.

(M<sup>1</sup>) Material moved to Contents Page 4.

(M<sup>1</sup>)

(N)

(N)

A200. LOCAL EXCHANGE SERVICE AREA MAPS AND DESCRIPTIONS

<u>EXCHANGE</u>		<u>CONTENTS</u>	<u>Page No.</u>	
A200.23	<u>Winter Haven</u>			(M)
	A200.23.1	(Deleted)		
	A200.23.2	Exchange Area Description	102	
	A200.23.3	Exchange Service Area Map	104	
A200.24	<u>Zephyrhills</u>			(D)
	A200.24.1	Exchange Area Description	105	(C)
	A200.24.2	Exchange Service Area Map	107	(M) (C)

(M) Material moved from Contents Page 3.

(N)

A200. LOCAL EXCHANGE SERVICE AREA MAPS AND DESCRIPTIONS

A200.7 Hudson

.1 Exchange Area Description by Metes and Bounds

Beginning at a point where the Hernando-Pasco County Line intersects the shoreline of the Gulf of Mexico; then eastwardly along the south shoreline of Smith Hammock Creek to the north-south half-section line of Section 36, T 23 S, R 16 E; then north along half-section line to the northwest corner of the southwest quarter of the southeast quarter of said Section 36, T 23 S, R 16 E; then east one-half mile; then south one-quarter mile to the northeast corner of Section 1, T 24 S, R 16 E (Hernando-Pasco County Line); then east along Hernando-Pasco County Line seven and one-half miles to the northeast corner of the northwest quarter of Section 5, T 24 S, R 18 E; then south one-half mile; then east one-half mile to the northeast corner of the southeast quarter of said Section 5, T 24 S, R 18 E; then south along section lines to the southern shoreline of Crews Lake; then southwest along shoreline to the center of the Pithlachascotee River; then southwest along run of said river to the intersection with the southeast corner of Section 30, T 24 S, R 18 E; then west along the northern section line of Section 31, T 24 S, R 18 E (N) approximately one mile, then west along the northerly boundary approximately three quarters of a mile of Section 36, (N) T 24 S R 17 E to centerline of Hays Road; then southerly along the centerline of Hays Road approximately one-half (N) mile to the east-west one-half mile section line of Section 36, T 24 S, R 17 E, then west along said one-half section line approximately 977 feet to the west boundary of said Section 36; then south to the southeast section corner of (N) (D) Section 36, T 24 S, R 17 E; then south approximately 882 feet, then northerly following the northerly and easterly (N) boundary of the subdivision called Serengetti in Pasco County to a point on the northerly boundary of Section 6, T 25 E, R 18 E; then travel southeasterly along the south border of the Serengetti subdivision approximately 2420 feet; then head westerly along the southern boundary of the Serengetti subdivision to the west boundary of Section 1, T 25 E, R 17 E; then south approximately 8479 feet to the southeast section corner of Section 11, T 25 E, R 17 E; then west approximately 193 feet; then south westerly approximately 603 feet; then south westerly (N)

(M)

(M)  
(N)

(M) Material moved to Page 25.

A200. LOCAL EXCHANGE SERVICE AREA MAPS AND DESCRIPTIONS

A200.7 Hudson (Continued)

approximately 1020 feet; then northeast approximately 1256 feet; then south along the section lines approximately (M)  
 3 and three quarter miles to the southwest section corner of Section 36, T 25 E, R 17 E; then west along said  
 township line four miles; then north along section lines two miles the southwest corner of Section 20, T 25 S, R 17 E;  
 then west along section lines three miles; then north along section line one mile to the southwest corner of Section  
 14, T 25 S, R 16 E; then west along section lines approximately three and one-eighth miles to the Gulf of Mexico;  
 then northeastwardly along shoreline of the Gulf of Mexico to point of beginning. (M)

(M) Material moved from Page 24.

(N)



A200. LOCAL EXCHANGE SERVICE AREA MAPS AND DESCRIPTIONS

A200.7 Hudson Continued)

.2 Exchange Service Area Map

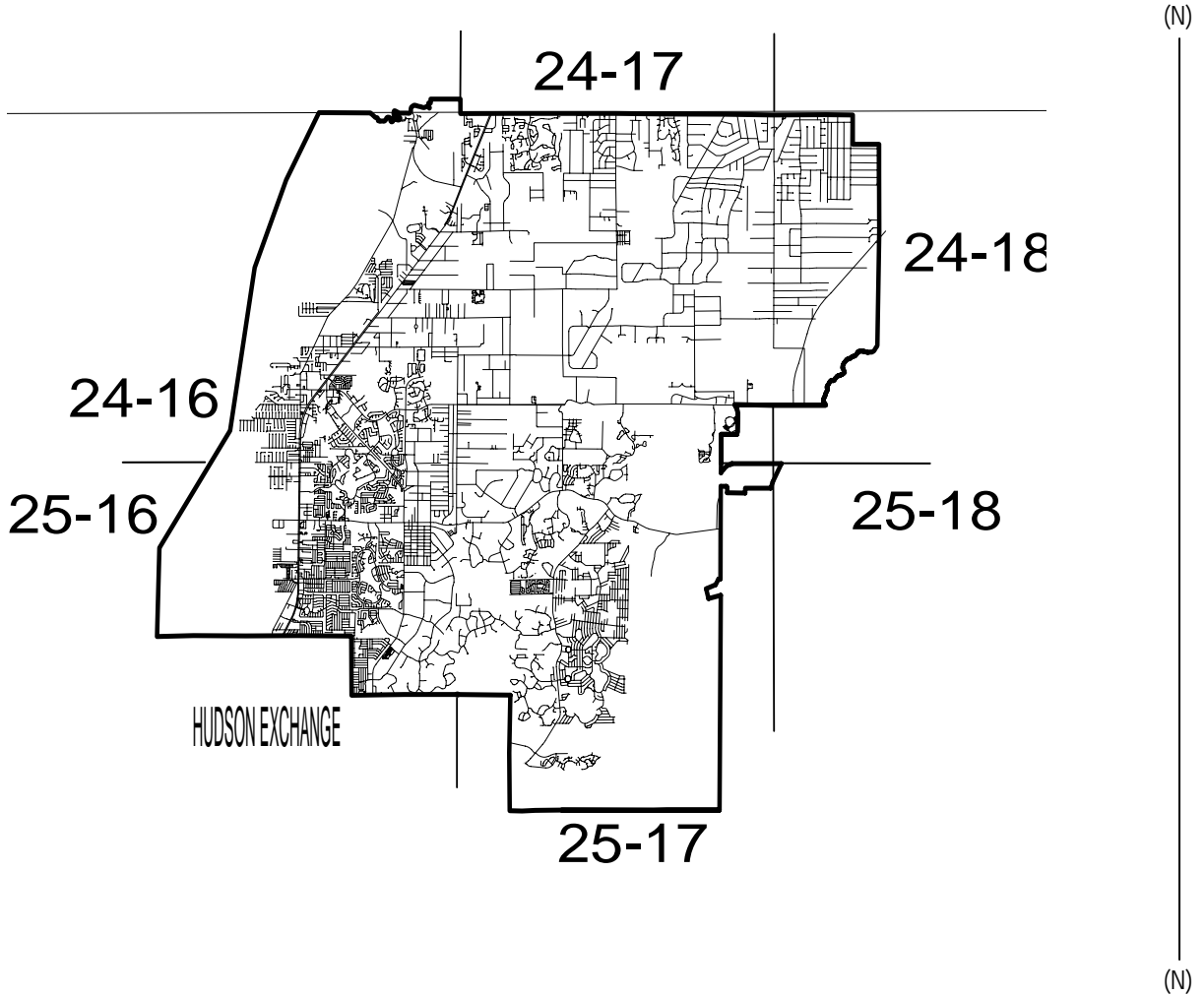

A200. LOCAL EXCHANGE SERVICE AREA MAPS AND DESCRIPTIONS

A200.12 Myakka

.2 Exchange Service area Map

(C)

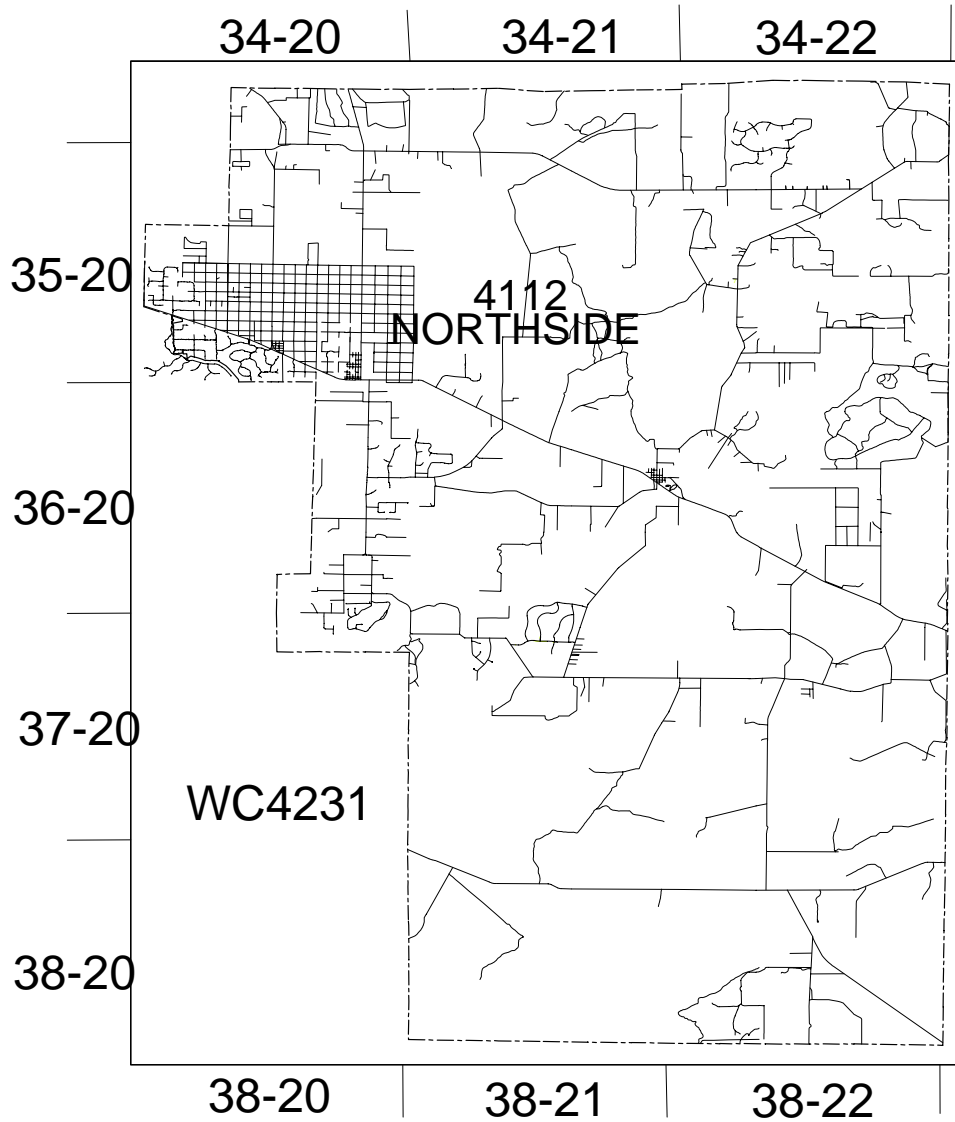

## A200. LOCAL EXCHANGE SERVICE AREA MAPS AND DESCRIPTIONS

A200.19 Sarasota (Continued)

(C)

## .1 Exchange area Description by Metes and Bounds (Continued)

(C)

right-of-way of State Road No. 70 as shown on F.D.O.T. right-of-way maps, Section 13160-2506; thence N69°D56'53"W, along said southerly right-of-way, a distance of 4788.43 feet to a point on the westerly line of Section 30, Township 35 south, range 20 east, lying S00°30'07"W, a distance of 939.41 feet from the northwest corner of Section 30, Township 35 south, range 20 east; thence S00°D30'07"W, along said westerly line, a distance of 4342.75 feet returning to aforesaid "Point A" (the southwest corner of said Section 30, same being the northwest corner of Section 31, Township 35 south, range 20 east); thence returning to aforesaid "Point B" continue along aforesaid county line to a point where the east section line of Section 34, T 35 S, R 20 E intersects the north section line of Section 3, T 36 S, R 20 E; then south five miles; then west approximately three-quarters mile to the northeast corner of Section 33, T 36 S, R 20 E; then south two miles; then east three miles; then south eight miles to the southeast corner of Section 13, T 38 S, R 20 E; then west along section lines six miles to the southwest corner of Section 18, T 38 S, R 20 E; then north along range line between R 19 E and R 20 E four miles; then west along section lines three miles; then north along section lines one and one-quarter miles to the southeast corner of the northeast quarter of the southeast quarter of Section 21, T 37 S, R 19 E; then west along quarter-section lines three miles to the northeast corner of the southeast quarter of Section 24, T 37 S, R 18 E; then south along section line two and one-quarter miles to the southeast corner of Section 36, T 37 S, R 18 E; then west along section line approximately one mile to the intersection with the Seaboard Coast Line Railroad in Section 35, T 37 S, R 18 E; then northwestwardly along said railroad approximately one mile to the south section line of Section 26, T 37 S, R 18 E; then west along section line approximately one and one-half miles to the centerline of U.S. Highway 41; then northwestwardly along said centerline approximately one-half mile to the intersection with the west boundary line of Section 27, T 37 S, R 18 E; then south along section line (Beneva and Vamo Roads) to the half-section line of fractional Section 28, T 37 S, R 18 E; then west along said half-section line approximately 823 feet; then south to Clower Creek; then southwestwardly through said creek to the intersection of a line approximately 1700 feet north of and parallel to the south boundary of fractional Section 28, T 37 S, R 18 E; then west along said line approximately 800 feet into Little Sarasota Bay; then westwardly and southwestwardly through Little Sarasota Bay to a point south of Midnight Pass; then northwestwardly through Midnight Pass into the Gulf of Mexico; then northwestwardly along the shoreline of the Gulf of Mexico to point of beginning.

A200. LOCAL EXCHANGE SERVICE AREA MAPS AND DESCRIPTIONS

A200.19 Sarasota

.2 Exchange Service area Map

(C)

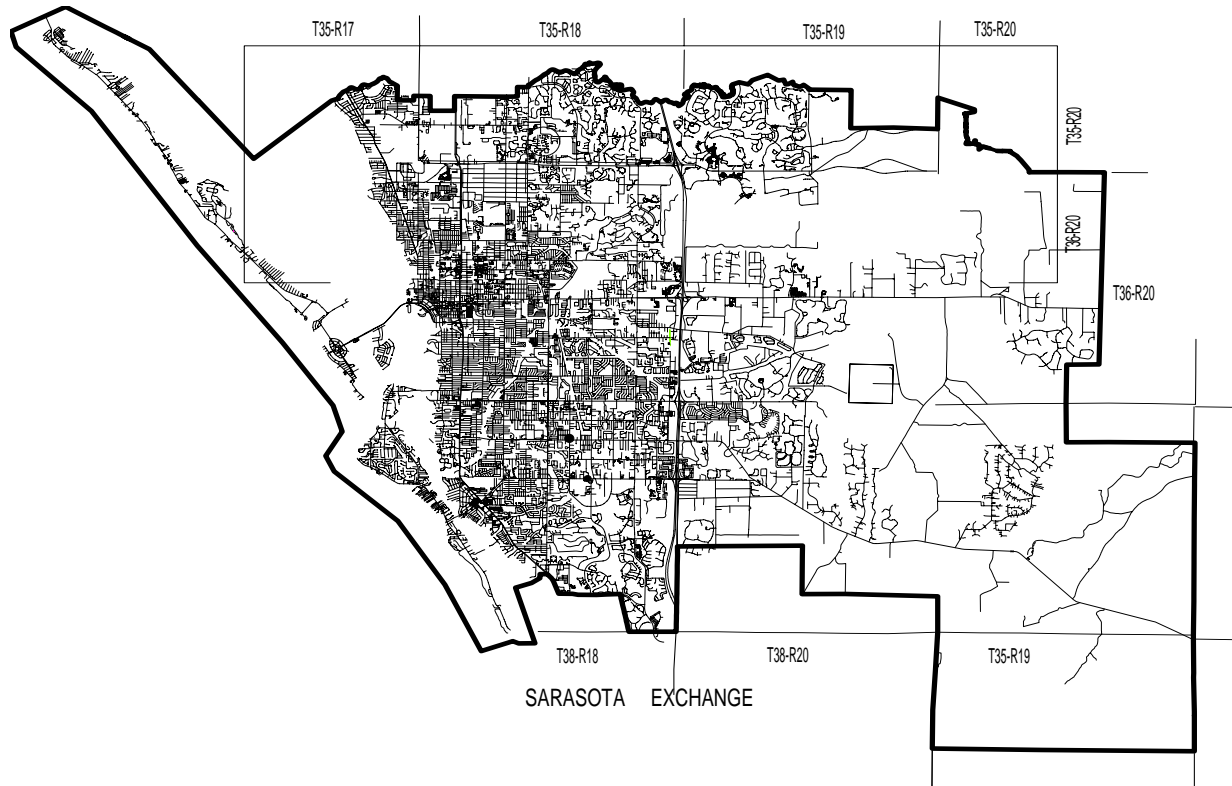

A200. LOCAL EXCHANGE SERVICE AREA MAPS AND DESCRIPTIONS

A200.20 Tampa (Continued)

.7 Tampa-North

A. Area Description by Metes and Bounds

Beginning at the northwest corner of Section 5, T 24 S, R 19 E; then east along the Hernando-Pasco County Line two and three-quarters miles to the northeast corner of the northwest quarter of the northeast quarter of Section 3, T 24 S, R 19 E; then south along quarter-section lines one mile to the northeast corner of the northwest quarter of the northeast quarter of Section 10, T 24 S, R 19 E; then east along section lines one-quarter mile to the northeast corner of Section 10, T 24 S, R 19 E; then south along section lines five miles; then east along section lines one mile; then south along section lines three miles; then east along section lines one mile; then south along section lines one mile to the northeast corner of Section 25, T 25 S, R 19 E; then east along section lines four miles; then south along section lines three miles; then west along half-section lines one and one-half miles to the southwest corner of the northeast quarter of Section 10, T 26 S, R 20 E; then south along half-section lines approximately three-quarters mile; then west approximately 900 feet to the centerline of Meadow Pointe Blvd; then south approximately 5340 feet; then west approximately 1617 feet; then south approximately 5200 feet; then west approximately 2070 feet to the west section line of Section 26, T 26, R 20 E; then south approximately 9533 feet to the southeast section corner of Section 35, T 26, R 20 E; then west approximately 7969 feet to the center section line of Section 4, T 27, R 20 E; then south approximately one mile to the southern section line of Section 4, T 27, R 20 E; then east approximately 1995 feet; then app. 1553 feet, southeasterly; then east app. 1297 feet northeasterly; then app. 1134 feet northeasterly along the northern border of Heritage Isles Phase 1; then app. 3959 feet east along the same border; then south 4999 feet; then west app. 3285 feet; then south app. 590'; then west app. 4075 feet; then south app. One mile to the southern section line of Section 16, T 27, R 20 E; then west app. 13751 feet to the northwest section corner of Section 19, T 27, R 20 E; then south app. 2749 feet; then west app. 3535 feet along the half section line of Section 24, T 27, R 20E to Trout Creek; then northerly along the meandering of

(M) Material moved to Page 83.

(M)  
 (M)  
 (N)

A200. LOCAL EXCHANGE SERVICE AREA MAPS AND DESCRIPTIONS

A200.20 Tampa (Continued)

.7 Tampa-North (Continued)

A. Area Description By Metes and Bounds (Continued)

said creek to where said creek intersects State Road 581; then in a northeastwardly and northerly direction (M)

along the center line of State Road 581 to the intersection of the east-west quarter section line of the southern quarter of Section 12, T 27 S, R 19 E; then westwardly along quarter section lines to the intersection of said quarter section line with Interstate Highway 75; then northwestwardly along the center line of interstate 75 to a point where said thoroughfare intersects with Interstate Highway 275 at the junction of the Hillsborough-Pasco County line; then southwestwardly along the center line of Interstate Highway 275 approximately six miles to the Seaboard Coast Line Railroad track; then northwestwardly along said railroad track approximately one (M)

and one-quarter miles to the south boundary of Section 24, T 27 S, R 18 E; then west on section lines approximately one and three-quarters miles to the southwest corner of the southeast quarter of the southeast quarter of Section 22, T 27 S, R 18 E; then north along quarter-section lines two miles to the northwest corner of the northeast quarter of the northeast quarter of Section 15, T 27 S, R 18 E; then west along section lines four miles, then north along section lines one mile to Lutz-Lake Fern Road; then southeasterly along Lutz-Lake Fern Road approximately two and one-eight miles, then north approximately 14,443 feet; then west approximately 583 feet to the west section line of Section 28, T 26, R 18 E; then north approximately 8217 feet; then southwestly approximately 5503 feet; then north approximately 16953 feet to the southwest section corner of Section 32, T 25, R 18 E; then west approximately two miles to the southwest section corner of Section 36, T 25, R 17 E; then north approximately 19620 feet; then travel southwestly approximately 1256 feet; then northwestly approximately 921 feet; then northeasterly approximately 1020 feet; then more northeasterly approximately 603 feet; then east approximately 193 feet to the southwest section corner of Section 12, T 25, R 17 E; then travel north along the section line approximately 8479 feet to (D) (N)

(D)

(M<sup>1</sup>)

(M<sup>1</sup>)

(N)

(N)

(M) Material moved from Page 82.

(M<sup>1</sup>) Material moved to Page 83.1.

A200. LOCAL EXCHANGE SERVICE AREA MAPS AND DESCRIPTIONS

A200.20 Tampa (Continued)

.7 Tampa-North (Continued)

A. Area Description by Metes and Bounds (Continued)

a point on the east section line of Section 2, T 25 S, R 17 E; then head easterly along the southern boundaries of the Serengetti subdivision in Pasco County until such boundary intersects the southern section line of Section 31, T 24 S, R 18 E; then travel westerly approximately 8,852 feet along the northern boundary of the Serengetti subdivision in Pasco County; then travel southwesterly along the northern boundary of the Serengetti subdivision until you intersect the east section line of Section 2, T 25 S, R 17 E; then travel north approximately 3,516 feet along such section line to a point being the center line intersection of the west section line of Section 36, T 25 S, R 17 E; then travel east approximately 977 feet; then head northeasterly following Hays Road approximately 239.66 feet; then travel north approximately 1703.79 feet, then head northwest 216.22 feet; then travel northwest approximately 370.05 feet to the intersection of the northern section line of Section 36, T 24 S, R 17 E in which Hays Road and Hudson Avenue intersect; then travel east approximately 3873 feet along the northern section line of Section 36, T 24 S, R 17 E until you reach the northeast section corner of Section 36, T 24 S, R 17 E; then continue traveling east approximately one mile along the north section line of Section 31, T 24 S, R 18 S until you reach the northeast section corner of said section; then travel northwesterly approximately 580 feet until the intersection of center of the Pithlachascotee River; to the north boundary Section 36 T 24 S, R 17 E; then east along the section line to the center of the Pithlachascotee River; then northeastwardly along the run of the Pithlachascotee River to the southern shoreline of Crews Lake, then northeast along the shoreline of Crews Lake to the northeast corner of Section 29, T 24 S; R 18 E; then east along section lines five miles; then north along section lines four miles to point of beginning.

(N)

(N) (M)

(M)

(M) Material moved from Page 83.

(N)

A200. LOCAL EXCHANGE SERVICE AREA MAPS AND DESCRIPTIONS

A200.20 Tampa (Continued)

.7 Tampa-North (Continued)

B. Service Area Map

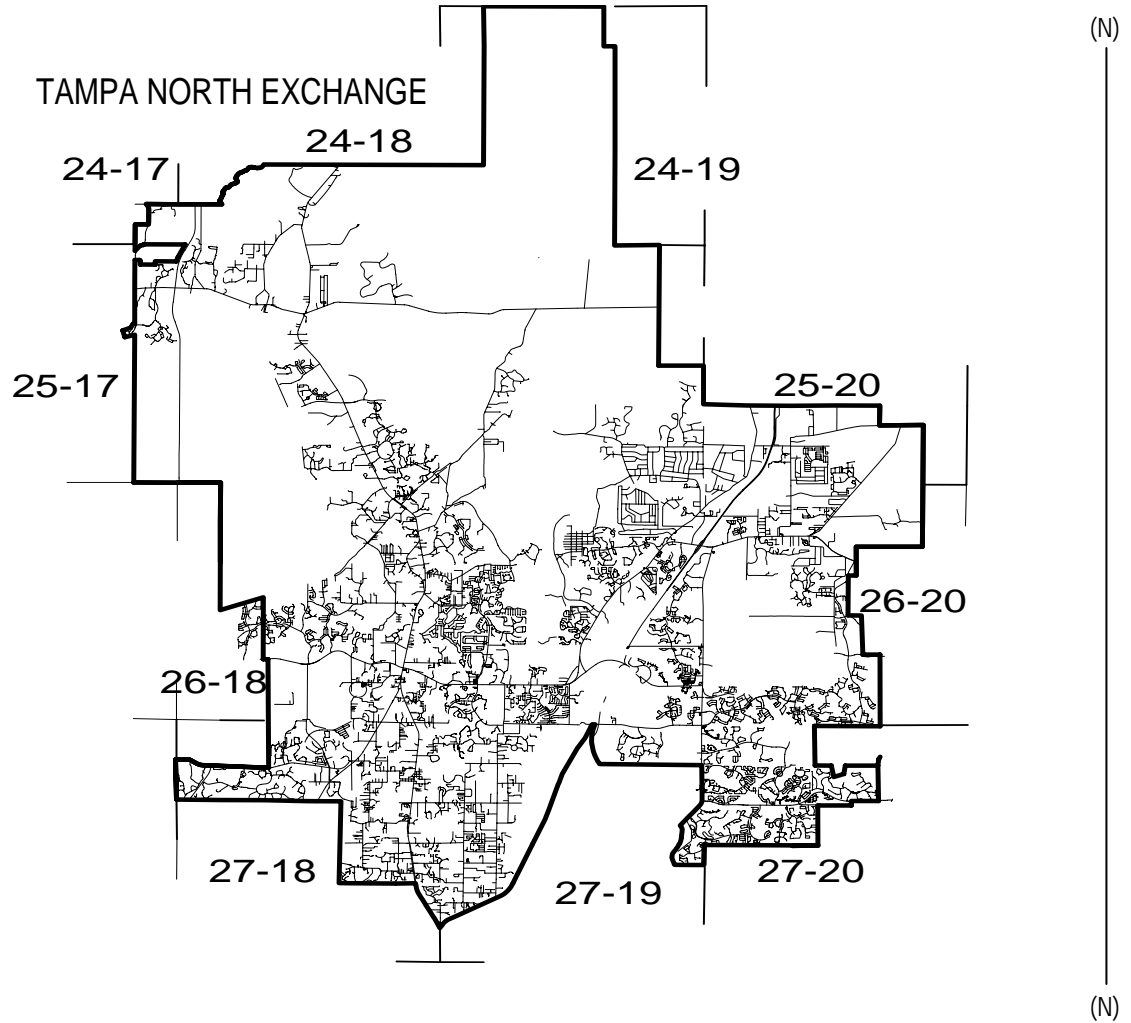



A200. LOCAL EXCHANGE SERVICE AREA MAPS AND DESCRIPTIONS

	<u>EXCHANGE</u>	<u>CONTENTS</u>	<u>Page No.</u>	
A200.1	<u>Bartow</u>			
	A200.1.1	(Deleted)		
	A200.1.2	Exchange Area Description	2	
	A200.1.3	Exchange Service Area Map	3	
A200.2	<u>Bradenton</u>			
	A200.2.1	(Deleted)		
	A200.2.2	Exchange Area Description	5	
	A200.2.3	Exchange Service Area Map	7	
A200.3	<u>Clearwater</u>			
	A200.3.1	(Deleted)		
	A200.3.2	Exchange Area Description	9	
	A200.3.3	Exchange Service Area Map	11	
A200.4	<u>Englewood</u>			
	A200.4.1	(Deleted)		
	A200.4.2	Exchange Area Description	13	
	A200.4.3	Exchange Service Area Map	14	
A200.5	<u>Frostproof</u>			
	A200.5.1	(Deleted)		
	A200.5.2	Exchange Area Description	16	
	A200.5-3	Exchange Service Area Map	17	
A200.6	<u>Haines City</u>			
	A200.6.1	(Deleted)		
	A200.6.2	Exchange Area Description	19	
	A200.6.3	Exchange Service Area Map	21	
	A200.6.4	Poinciana Exception Area by Metes and Bounds	22	
	A200.6.5	Poinciana Exception Area Service Map	23	
A200.7	<u>Hudson</u>			
	<del>A200.7.1</del>	<del>(Deleted)</del>		<del>(D)</del>
	A200.7.12	Exchange Area Description	245	(C)
	A200.7.23	Exchange Service Area Map	26	(C)
A200.8	<u>Indian Lake</u>			
	A200.8.1	(Deleted)		
	A200.8.2	Exchange Area Description	28	
	A200.8.3	Exchange Service Area Map	29	
<del>A200.9</del>	<del><u>Lakeland</u></del>			<del>(M)</del>
	<del>A200.9.1</del>	<del>(Deleted)</del>		
	<del>A200.9.2</del>	<del>Exchange Area Description</del>	<del>31</del>	
	<del>A200.9.3</del>	<del>Exchange Service Area Map</del>	<del>32</del>	
<del>A200.10</del>	<del><u>Lake Wales</u></del>			<del>(M)</del>
	<del>A200.10.1</del>	<del>(Deleted)</del>		
	<del>A200.10.2</del>	<del>Exchange Area Description</del>	<del>34</del>	
	<del>A200.10.3</del>	<del>Exchange Service Area Map</del>	<del>35</del>	<del>(M)</del>

(M) Material moved to Contents Page 2.

(N)

A200. LOCAL EXCHANGE SERVICE AREA MAPS AND DESCRIPTIONS

<u>EXCHANGE</u>	<u>CONTENTS</u>	<u>Page No.</u>	
A200.9	<u>Lakeland</u>		(M)
	A200.9.1 (Deleted)		
	A200.9.2 Exchange Area Description	31	
	A200.9.3 Exchange Service Area Map	32	
A200.10	<u>Lake Wales</u>		
	A200.10.1 (Deleted)		
	A200.10.2 Exchange Area Description	34	
	A200.10.3 Exchange Service Area Map	35	(M)
A200.11	<u>Mulberry</u>		
	A200.11.1 (Deleted)		
	A200.11.2 Exchange Area Description	37	
	A200.11.3 Exchange Service Area Map	38	
A200.12	<u>Myakka</u>		
	<del>A200.12.1 (Deleted)</del>		(D)
	A200.12.1 <del>2</del> Exchange Area Description	39 <del>40</del>	(C)
	A200.12.2 <del>3</del> Exchange Service Area Map	41	(C)
A200.13	<u>New Port Richey</u>		
	A200.13.1 (Deleted)		
	A200.13.2 Exchange Area Description	43	
	A200.13.3 Exchange Service Area Map	44	
A200.14	<u>North Port</u>		
	A200.14.1 (Deleted)		
	A200.14.2 Exchange Area Description	46	
	A200.14.3 Exchange Service Area Map	47	
A200.15	<u>Palmetto</u>		
	A200.15.1 (Deleted)		
	A200.15.2 Exchange Area Description	49	
	A200.15.3 Exchange Service Area Map	50	
A200.16	<u>Plant City</u>		
	A200.16.1 (Deleted)		
	A200.16.2 Exchange Area Description	53	
	A200.16.3 Exchange Service Area Map	55	
<del>A200.17</del>	<del><u>Polk City</u></del>		(M)
	<del>A200.17.1 (Deleted)</del>		
	<del>A200.17.2 Exchange Area Description</del>	<del>58</del>	
	<del>A200.17.3 Exchange Service Area Map</del>	<del>59</del>	
<del>A200.18</del>	<del><u>St. Petersburg</u></del>		
	<del>A200.18.1 (Deleted)</del>		
	<del>A200.18.2 Exchange Area Description</del>	<del>61</del>	
	<del>A200.18.3 Exchange Service Area Map</del>	<del>63</del>	
<del>A200.19</del>	<del><u>Sarasota</u></del>		
	<del>A200.19.1 (Deleted)</del>		
	<del>A200.19.2 Exchange Area Description</del>	<del>65</del>	
	<del>A200.19.3 Exchange Service Area Map</del>	<del>67</del>	
<del>A200.20</del>	<del><u>Tampa</u></del>		
	<del>A200.20.1 (Deleted)</del>		
	<del>A200.20.2 Exchange Area Description</del>	<del>71</del>	
	<del>A200.20.3 Exchange Service Area Map</del>	<del>74</del>	
	<del>A200.20.4 Metropolitan Exchange Service Area Map</del>	<del>77</del>	
	<del>A200.20.5 Airport Service Area Map</del>	<del>78</del>	

(M) Material moved from Contents Page 2.

(M') Material moved to Contents Page 3.

**A200. LOCAL EXCHANGE SERVICE AREA MAPS AND DESCRIPTIONS**

		<u>CONTENTS</u>	<u>Page No.</u>	
<u>EXCHANGE</u>				
<del>A200.17</del>	<del>Polk City</del>			<del>(M)</del>
	<del>A200.17.1</del>	<del>(Deleted)</del>		
	<del>A200.17.2</del>	<del>Exchange Area Description</del>	<del>58</del>	
	<del>A200.17.3</del>	<del>Exchange Service Area Map</del>	<del>59</del>	
<del>A200.18</del>	<del>St. Petersburg</del>			
	<del>A200.18.1</del>	<del>(Deleted)</del>		
	<del>A200.18.2</del>	<del>Exchange Area Description</del>	<del>61</del>	
	<del>A200.18.3</del>	<del>Exchange Service Area Map</del>	<del>63</del>	
<del>A200.19</del>	<del>Sarasota</del>			
	<del>A200.19.1</del>	<del>(Deleted)</del>		<del>(D)</del>
	<del>A200.19.2</del>	<del>Exchange Area Description</del>	<del>654</del>	<del>(C)</del>
	<del>A200.19.3</del>	<del>Exchange Service Area Map</del>	<del>67</del>	<del>(C)</del>
<del>A200.20</del>	<del>Tampa</del>			
	<del>A200.20.1</del>	<del>(Deleted)</del>		
	<del>A200.20.2</del>	<del>Exchange Area Description</del>	<del>71</del>	
	<del>A200.20.3</del>	<del>Exchange Service Area Map</del>	<del>74</del>	
	<del>A200.20.4</del>	<del>Metropolitan Exchange Service Area Map</del>	<del>77</del>	
	<del>A200.20.5</del>	<del>Airport Service Area Map</del>	<del>78</del>	<del>(M)</del>
	A200.20.6	Tampa-Central	79	
	A200.20.7	Tampa-North	82	
	A200.20.8	Tampa-East	85	
	A200.20.9	Tampa-South	89	
	A200.20.10	Tampa-West	91	
<del>A200.21</del>	<del>Tarpon Springs</del>			
	<del>A200.21.1</del>	<del>(Deleted)</del>		
	<del>A200.21.2</del>	<del>Exchange Area Description</del>	<del>95</del>	
	<del>A200.21.3</del>	<del>Exchange Service Area Map</del>	<del>97</del>	
<del>A200.22</del>	<del>Venice</del>			
	<del>A200.22.1</del>	<del>(Deleted)</del>		
	<del>A200.22.2</del>	<del>Exchange Area Description</del>	<del>99</del>	
	<del>A200.22.3</del>	<del>Exchange Service Area Map</del>	<del>100</del>	
<del>A200.23</del>	<del>Winter Haven</del>			<del>(M)</del>
	<del>A200.23.1</del>	<del>(Deleted)</del>		
	<del>A200.23.2</del>	<del>Exchange Area Description</del>	<del>102</del>	
	<del>A200.23.3</del>	<del>Exchange Service Area Map</del>	<del>104</del>	
<del>A200.24</del>	<del>Zephyrhills</del>			
	<del>A200.24.1</del>	<del>(Deleted)</del>		
	<del>A200.24.2</del>	<del>Exchange Area Description</del>	<del>106</del>	
	<del>A200.24.3</del>	<del>Exchange Service Area Map</del>	<del>107</del>	<del>(M)</del>

(M) Material moved from Contents Page 3.

(M) Material moved to Contents Page 4.

(N)

(N)

A200. LOCAL EXCHANGE SERVICE AREA MAPS AND DESCRIPTIONS

CONTENTS

<u>EXCHANGE</u>		<u>Page No.</u>	
<u>A200.23 Winter Haven</u>			<u>(M)</u>
A200.23.1	(Deleted)		
A200.23.2	Exchange Area Description	102	
A200.23.3	Exchange Service Area Map	104	
<u>A200.24 Zephyrhills</u>			<u>(D)</u>
A200.24.1	Exchange Area Description	105	<u>(C)</u>
A200.24.2	Exchange Service Area Map	107	<u>(M) (C)</u>

(M) Material moved from Contents Page 3.

(N)

A200. LOCAL EXCHANGE SERVICE AREA MAPS AND DESCRIPTIONS

A200.7 Hudson

.1 Exchange Area Description by Metes and Bounds

Beginning at a point where the Hernando-Pasco County Line intersects the shoreline of the Gulf of Mexico; then eastwardly along the south shoreline of Smith Hammock Creek to the north-south half-section line of Section 36, T 23 S, R 16 E; then north along half-section line to the northwest corner of the southwest quarter of the southeast quarter of said Section 36, T 23 S, R 16 E; then east one-half mile; then south one-quarter mile to the northeast corner of Section 1, T 24 S, R 16 E (Hernando-Pasco County Line); then east along Hernando-Pasco County Line seven and one-half miles to the northeast corner of the northwest quarter of Section 5, T 24 S, R 18 E; then south one-half mile; then east one-half mile to the northeast corner of the southeast quarter of said Section 5, T 24 S, R 18 E; then south along section lines to the southern shoreline of Crews Lake; then southwest along shoreline to the center of the Pithlachascotee River; then southwest along run of said river to the intersection with the southeast corner of Section 30, T 24 S, R 18 E; then west along the northern section lines of Section 31, T 24 S, R 18 E (N) approximately one mile, then west along the northerly boundary approximately three quarters of a mile of Section 36, (N) T 24 S, R 17 E, to the centerline of Hays Road; then southerly along the centerline of Hays Road approximately one- (N) half mile to the east-west one-half mile section line of Section 36, T 24 S, R 17 E-, then West along said one-half section line approximately 977 feet to the west boundary of said Section 36; ~~then south along section lines two and (D) one-half miles to southwest section corner of Section 12, T 25 S, R 17 E;~~ then south to the southeast section (D) (N) corner of Section 36, T 24 S, R 17 E; then south approximately approximately 882 feet, then northerly following the northerly and easterly boundary of the subdivision called Serengetti in Pasco County to a point on the northerly boundary of Section 6, T 25 E, R 18 E; then travel southeasterly along the south border of the Serengetti subdivision approximately 2420 feet; then westerly along the southern boundary of the Serengetti subdivision to the west boundary of Section 1, T 25 E, R 17 E; then south approximately 8479 feet to the southeast section (M) corner of Section 11, T 25 E, R 17 E; then west approximately 193 feet; then south westerly approximately 603 (N) feet; then ~~south westerly approximately 1020 feet; then northeast approximately 1256 feet; then south along the (M) section lines approximately 3 and three quarter miles to the southwest section corner of Section 36, T 25 E, R 17 E;~~ then west along said township line four miles; then north along section lines two miles the southwest corner of Section 20, T 25 S, R 17 E; then west along section lines three miles; then north along section line one mile to the southwest corner of Section 14, T 25 S, R 16 E; then west along section lines approximately three and one eighth miles to the Gulf of Mexico; then northeastwardly along shoreline of the Gulf of Mexico to point of beginning. (M)

(M) Material moved to Page 25.

(N)

A200. LOCAL EXCHANGE SERVICE AREA MAPS AND DESCRIPTIONS

A200.7 Hudson (Continued)

westerly approximately 1020 feet; then northeast approximately 1256 feet; then south along the section lines approximately 3 and three quarter miles to the southwest section corner of Section 36, T 25 E, R 17 E; then west along said township line four miles; then north along section lines two miles the southwest corner of Section 20, T 25 S, R 17 E; then west along section lines three miles; then north along section line one mile to the southwest corner of Section 14, T 25 S, R 16 E; then west along section lines approximately three and one-eighth miles to the Gulf of Mexico; then northeastwardly along shoreline of the Gulf of Mexico to point of beginning. (M)

(M) Material moved from Page 24.

(N)

A200. LOCAL EXCHANGE SERVICE AREA MAPS AND DESCRIPTIONS

A200.7 Hudson Continued)

.2 Exchange Service Area Map

REPLACE  
MAP

(N)

(N)

A200. LOCAL EXCHANGE SERVICE AREA MAPS AND DESCRIPTIONS

A200.12 Myakka

~~.23~~ Exchange Service area Map

(C)

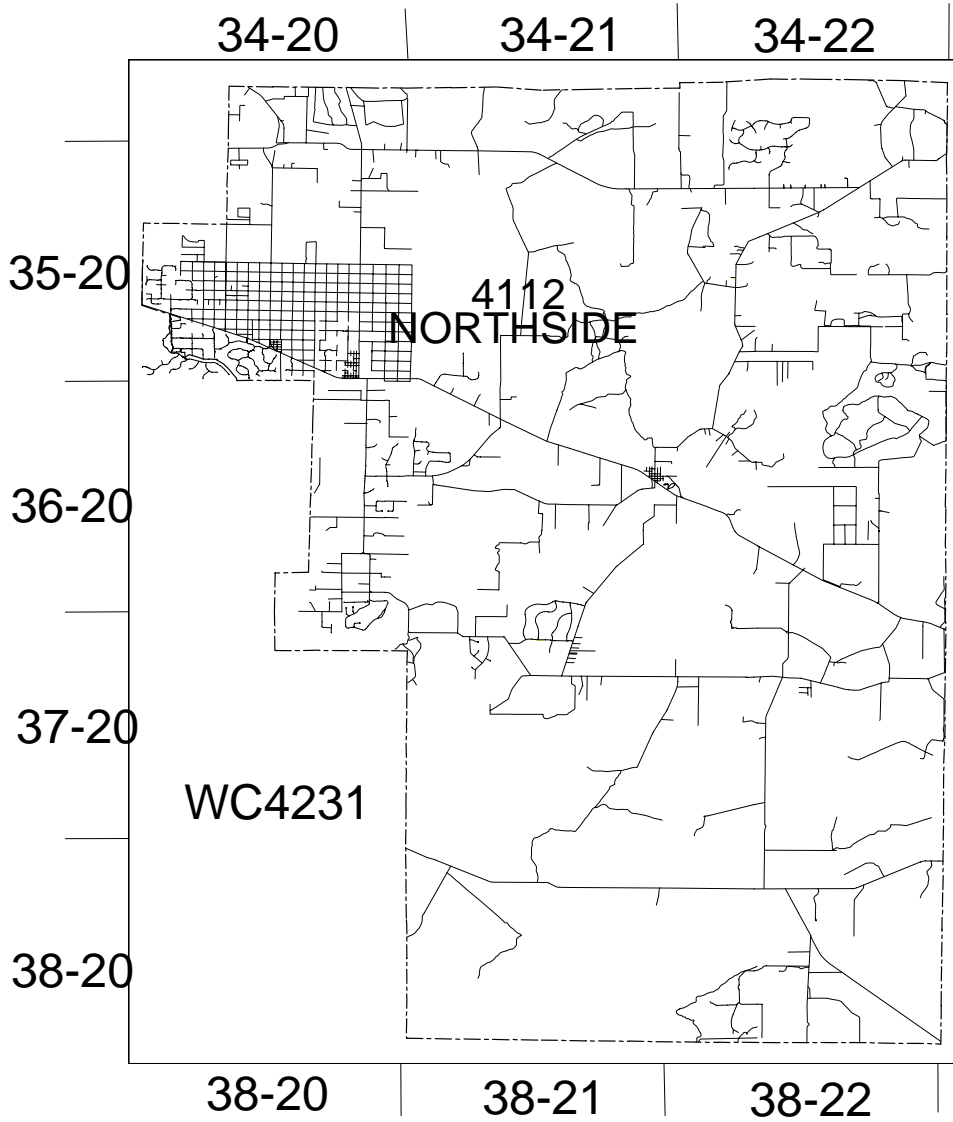



## A200. LOCAL EXCHANGE SERVICE AREA MAPS AND DESCRIPTIONS

~~a~~A200.19 Sarasota (Continued)

(C)

.12 Exchange area Description by Metes and Bounds (Continued)

(C)

right-of-way of State Road No. 70 as shown on F.D.O.T. right-of-way maps, Section 13160-2506; thence N69°D56'53"W, along said southerly right-of-way, a distance of 4788.43 feet to a point on the westerly line of Section 30, Township 35 south, range 20 east, lying S00°30'07"W, a distance of 939.41 feet from the northwest corner of Section 30, Township 35 south, range 20 east; thence S00°D30'07"W, along said westerly line, a distance of 4342.75 feet returning to aforesaid "Point A" (the southwest corner of said Section 30, same being the northwest corner of Section 31, Township 35 south, range 20 east); thence returning to aforesaid "Point B" continue along aforesaid county line to a point where the east section line of Section 34, T 35 S, R 20 E intersects the north section line of Section 3, T 36 S, R 20 E; then south five miles; then west approximately three-quarters mile to the northeast corner of Section 33, T 36 S, R 20 E; then south two miles; then east three miles; then south eight miles to the southeast corner of Section 13, T 38 S, R 20 E; then west along section lines six miles to the southwest corner of Section 18, T 38 S, R 20 E; then north along range line between R 19 E and R 20 E four miles; then west along section lines three miles; then north along section lines one and one-quarter miles to the southeast corner of the northeast quarter of the southeast quarter of Section 21, T 37 S, R 19 E; then west along quarter-section lines three miles to the northeast corner of the southeast quarter of Section 24, T 37 S, R 18 E; then south along section line two and one-quarter miles to the southeast corner of Section 36, T 37 S, R 18 E; then west along section line approximately one mile to the intersection with the Seaboard Coast Line Railroad in Section 35, T 37 S, R 18 E; then northwestwardly along said railroad approximately one mile to the south section line of Section 26, T 37 S, R 18 E; then west along section line approximately one and one-half miles to the centerline of U.S. Highway 41; then northwestwardly along said centerline approximately one-half mile to the intersection with the west boundary line of Section 27, T 37 S, R 18 E; then south along section line (Beneva and Vamo Roads) to the half-section line of fractional Section 28, T 37 S, R 18 E; then west along said half-section line approximately 823 feet; then south to Clower Creek; then southwestwardly through said creek to the intersection of a line approximately 1700 feet north of and parallel to the south boundary of fractional Section 28, T 37 S, R 18 E; then west along said line approximately 800 feet into Little Sarasota Bay; then westwardly and southwestwardly through Little Sarasota Bay to a point south of Midnight Pass; then northwestwardly through Midnight Pass into the Gulf of Mexico; then northwestwardly along the shoreline of the Gulf of Mexico to point of beginning.

A200. LOCAL EXCHANGE SERVICE AREA MAPS AND DESCRIPTIONS

A200.19 Sarasota

.23 Exchange Service area Map

(C)

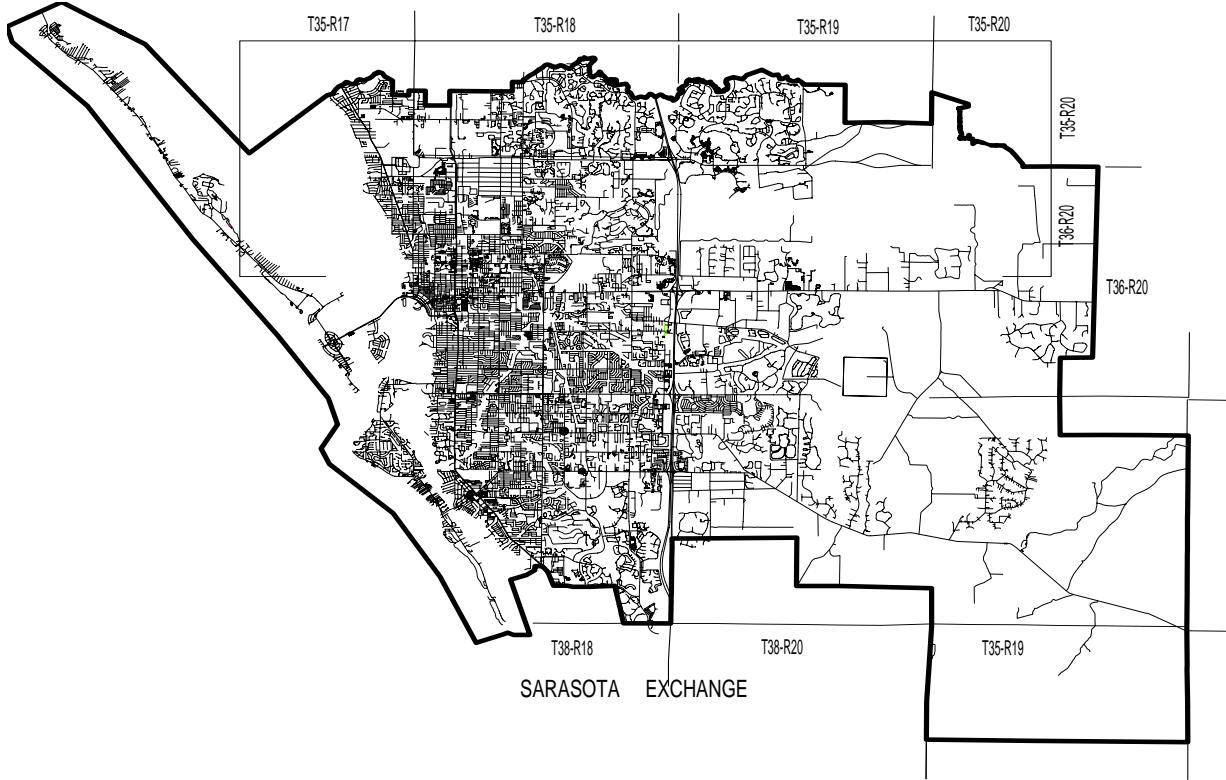

A200. LOCAL EXCHANGE SERVICE AREA MAPS AND DESCRIPTIONS

A200.20 Tampa (Continued)

.7 Tampa-North

A. Area Description by Metes and Bounds

Beginning at the northwest corner of Section 5, T 24 S, R 19 E; then east along the Hernando-Pasco County Line two and three-quarters miles to the northeast corner of the northwest quarter of the northeast quarter of Section 3, T 24 S, R 19 E; then south along quarter-section lines one mile to the northeast corner of the northwest quarter of the northeast quarter of Section 10, T 24 S, R 19 E; then east along section lines one-quarter mile to the northeast corner of Section 10, T 24 S, R 19 E; then south along section lines five miles; then east along section lines one mile; then south along section lines three miles; then east along section lines one mile; then south along section lines one mile to the northeast corner of Section 25, T 25 S, R 19 E; then east along section lines four miles; then south along section lines three miles; then west along half-section lines one and one-half miles to the southwest corner of the northeast quarter of Section 10, T 26 S, R 20 E; then south along half-section lines approximately three-quarters mile; then west approximately 900 feet to the centerline of Meadow Pointe Blvd; then south approximately 5340 feet; then west approximately 1617 feet; then south approximately 5200 feet; then west approximately 2070 feet to the west section line of Section 26, T 26, R 20 E; then south approximately 9533 feet to the southeast section corner of Section 35, T 26, R 20 E; then west approximately 7969 feet to the center section line of Section 4, T 27, R 20 E; then south approximately one mile to the southern section line of Section 4, T 27, R 20 E; then east approximately 1995 feet; then app. 1553 feet, southeasterly; then east app. 1297 feet northeasterly; then app. 1134 feet northeasterly along the northern border of Heritage Isles Phase 1; then app. 3959 feet east along the same border; then south 4999 feet; then west app. 3285 feet; then south app. 590'; then west app. 4075 feet; then south app. One mile to the southern section line of Section 16, T 27, R 20 E; then west app. 13751 feet to the northwest section corner of Section 19, T 27, R 20 E; then south app. 2749 feet; then west app. 3535 feet along the half section line of Section 24, T 27, R 20E to Trout Creek; then northerly along the meandering of ~~said creek to where said creek intersects State Road 581; then in a northeastwardly and northerly direction~~ (M) along the center line of State Road 581 to the intersection of the east west quarter section line of the southern quarter of Section 12, T 27 S, R 19 E; then westwardly along quarter section lines to the intersection of said quarter section line with Interstate Highway 75; then northwestwardly along the center line of interstate 75 to a point where said thoroughfare intersects with Interstate Highway 275 at the junction of the Hillsborough Pasco County line; then southwestwardly along the center line of Interstate Highway 275 approximately six miles to the Seaboard Coast Line Railroad track; then northwestwardly along said railroad track approximately one (M)

(M) Material moved to Page 83.

(N)

A200. LOCAL EXCHANGE SERVICE AREA MAPS AND DESCRIPTIONS

A200.20 Tampa (Continued)

.7 Tampa-North (Continued)

A. Area Description By Metes and Bounds (Continued)

~~said creek to where said creek intersects State Road 581; then in a northeastwardly and northerly direction along the center line of State Road 581 to the intersection of the east-west quarter section line of the southern quarter of Section 12, T 27 S, R 19 E; then westwardly along quarter section lines to the intersection of said quarter section line with Interstate Highway 75; then northwestwardly along the center line of interstate 75 to a point where said thoroughfare intersects with Interstate Highway 275 at the junction of the Hillsborough-Pasco County line; then southwestwardly along the center line of Interstate Highway 275 approximately six miles to the Seaboard Coast Line Railroad track; then northwestwardly along said railroad track approximately one and one-quarter miles to the south boundary of Section 24, T 27 S, R 18 E; then west on section lines approximately one and three-quarters miles to the southwest corner of the southeast quarter of the southeast quarter of Section 22, T 27 S, R 18 E; then north along quarter-section lines two miles to the northwest corner of the northeast quarter of the northeast quarter of Section 15, T 27 S, R 18 E; then west along section lines four miles, then north along section lines one mile to Lutz-Lake Fern Road; then southeasterly along Lutz-Lake Fern Road approximately two and one-eighth miles, then north approximately 14,443 feet; then west approximately 583 feet to the west section line of Section 28, T 26, R 18 E; then north approximately 8217 feet; then southwestwardly approximately 5503 feet; then north approximately 16953 feet to the southwest section corner of Section 32, T 25, R 18 E; then west approximately two miles to the southwest section corner of Section 36, T 25, R 17 E; then north approximately 19620 feet; then travel southwestwardly approximately 1256 feet; then northwestwardly approximately 921 feet; then northeasterly approximately 1020 feet; then more northeasterly approximately 603 feet; then east approximately 193 feet to the southwest section corner of Section 12, T 25, R 17 E; then north along the section lines approximately two and a half miles; then east along the east-west one-half section line of Section 36, T 24 S, R 17 E, to the centerline of Hays Road; then northerly along the centerline of Hays Road; to the north boundary Section 36 T 24 S, R 17 E; then travel north along the section line approximately 8479 feet to then east along the section line to the center of the Pithlachascotee River; then northeastwardly along the run of the Pithlachascotee River to the southern shoreline of Crews Lake, then northeast along the shoreline of Crews Lake to the northeast corner of Section 29, T 24 S, R 18 E; then east along section lines five miles; then north along section lines four miles to point of beginning.~~

(M)

(M)

(D)

(D)

(D)

(N) (D)

(D) (M)

(M)

(M) Material from Page 82.

(M') Material moved to Page 83.1.

(N)  
(N)

A200. LOCAL EXCHANGE SERVICE AREA MAPS AND DESCRIPTIONS

A200.20 Tampa (Continued)

.7 Tampa-North (Continued)

A. Area Description by Metes and Bounds (Continued)

a point on the east section line of Section 2, T25S, R17E; then head easterly along the southern boundaries of the Serengetti subdivision in Pasco County until such boundary intersects the southern section line of Section 31, T 24 S, R 18 E; then travel westerly approximately 8,852 feet along the northern boundary of the Serengetti subdivision in Pasco County; then travel southwesterly along the northern boundary of the Serengetti subdivision until you intersect the east section line of Section 2, T 25 S, R 1 7E; then travel north approximately 3,516 feet along such section line to a point being the center line intersection of the west section line of Section 36, T 25 S, R 17 E; then travel east approximately 977 feet; then head northeasterly following Hays Road approximately 239.66 feet; then travel north approximately 1703.79 feet, then head northwest 216.22 feet; then travel northwest approximately 370.05 feet to the intersection of the northern section line of Section 36, T 24 S, R 17 E in which Hays Road and Hudson Avenue intersect; then travel east approximately 3873 feet along the northern section line of Section 36, T 24 S, R 17E until you reach the northeast section corner of Section 36, T24S, R17E; then continue traveling east approximately one mile along the north section line of section 31, T24S, R18S until you reach the northeast section corner of said section; then travel northwesterly approximately 580 feet until the intersection of center of the Pithlachascotee River; then northeastwardly along the run of the Pithlachascotee River to the southern shoreline of Crews Lake, then northeast along the shoreline of Crews Lake to the northeast corner of Section 29, T 24 S; R 18 E; then east along section lines five miles; then north along section lines four miles to point of beginning.

(N)  
(M)  
(M)

(M) Material moved from Page 83.

(N)

A200. LOCAL EXCHANGE SERVICE AREA MAPS AND DESCRIPTIONS

A200.20 Tampa (Continued)

.7 Tampa-North (Continued)

B. Service Area Map

REPLACE  
MAP

(N)

(N)